

Westbuild PRO™ Specification

Enhancing Compressive Strength in Screed

Scope

With traditional sand and cement screeds, the ratio of cement, sand and water can vary considerably. By using Westbuild PRO™ Flexible Additive & Fortifier with either a factory-prepared screed (Westbuild Easy Screed) or a site-prepared screed, the water is replaced (and controlled better) with an SBR* admixture emulsion. The addition of Westbuild PRO™ admixture will greatly enhance final performance characteristics. Use Westbuild PRO™ Flexible Additive & Fortifier as an:

- Admixture for factory-blended Westbuild Easy Screed
- Admixture for site-prepared screeds

Product

Westbuild PRO™ Flexible Additive & Fortifier is a unique, multi-purpose liquid compatible with general cement-based tile adhesives, mortars, renders and screeds. Westbuild PRO™ Flexible Additive & Fortifier will greatly improve the technical properties and performance of cement-based systems and is suitable for areas subject to water, harsh climatic conditions and fully immersed areas.



Westbuild PRO™ Flexible Additive & Fortifier will increase tensile and compressive strength, promote improved adhesion to the subfloor whilst improving workability and water resistance.

Westbuild PRO™ Flexible Additive & Fortifier can also be used with neat cement as a bonding agent to assist in adhesion of cement screeds and mortars to the subfloor.

Preparation

Surface preparation is vital for optimum adhesion and results. Ensure all substrates are structurally sound and completely dry. Any repaired surfaces should be dry and cured prior to coating, be properly installed as per manufacturer's recommended installation methods and/or applicable Australian Standards.

Always add the Westbuild PRO™ Flexible Additive & Fortifier to gauging water in preparation for the project. Do not add the water and Flexible Additive & Fortifier separately. Use clean potable water and for optimal results use a 2:1 mix – i.e. mix 2 parts water to 1 part Flexible Additive & Fortifier. Weaker dilutions will still enhance the overall properties of the mix, but in a reduced manner.

For maximum strength and performance, or when applying the screed in a thin layer (to feather edge) Flexible Additive & Fortifier should be added neat (i.e. without the addition of water), in conjunction with a bonding slurry placed "wet" on "wet" with the subfloor.

Mixing & Application

Flexible Additive & Fortifier can be used in any cementitious compound to promote increased adhesion and cohesive characteristics. Refer to Fig 1, 'Dilution Guide' (next page), to assist in dilution ratios.

Priming Coat	Use Westbuild PRO™ General Purpose Primer and apply evenly and consistently. Over-coating with cementitious compounds whilst the primer is still tacky will achieve maximum adhesion.
Fortifying Admixture	Ensure correct dilution is used, mix thoroughly and consistently. If the mixed mortar starts to dry out DO NOT add any more water, discard and re-mix fresh product.

Westbuild PRO Flexible Additive & Fortifier with Easy Screed

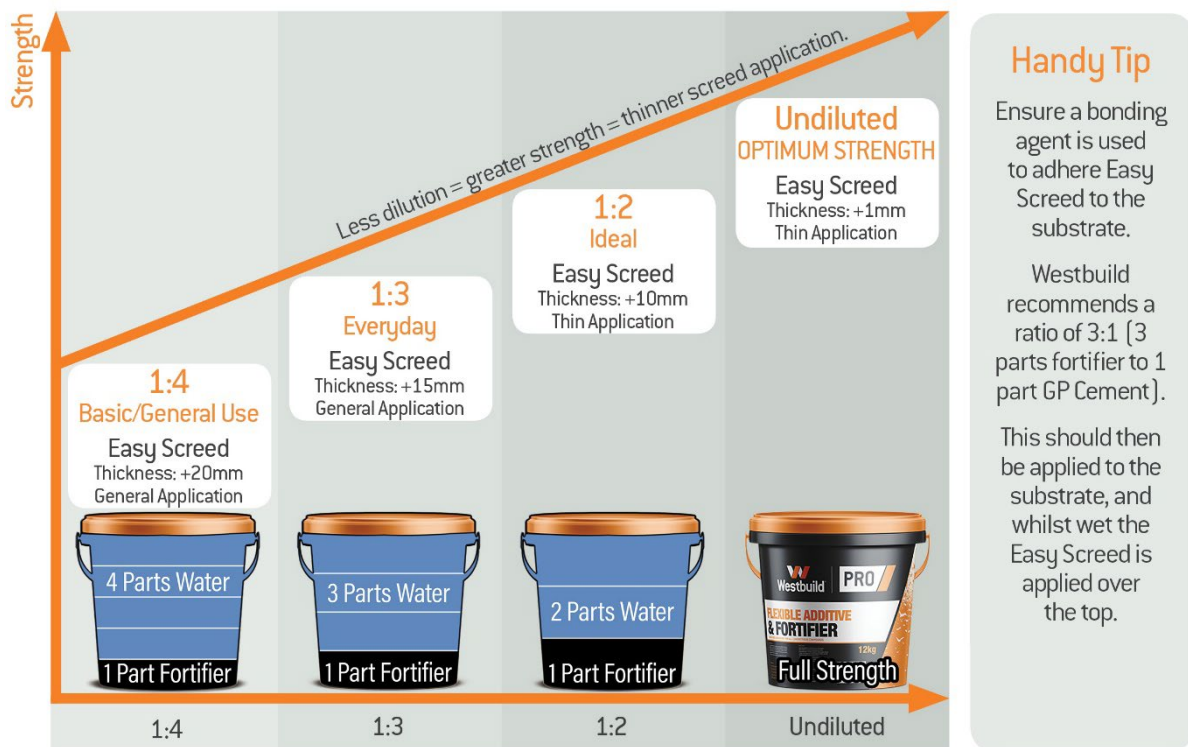
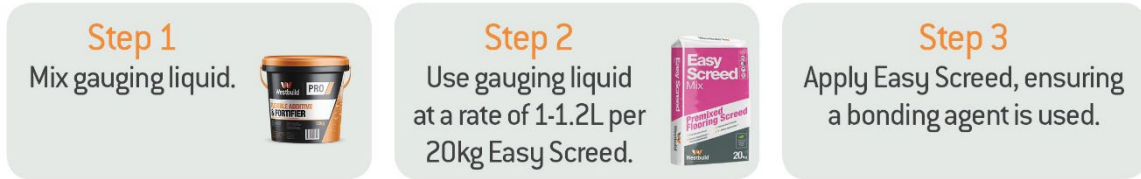

Fig 1. – Dilution Guide

Mechanical and Physical Properties

Form – Liquid	Colour	Milky White
	Specific Gravity	1kg/litre
Dilution Rates	Minimum	Neat, without dilution.
	Maximum	1:6 (1 Part Flexible Additive & Fortifier to 6 Parts Water)
Typical Reduction Drying Times	Mix ratio 1:2 (1 Part Flexible Additive & Fortifier to 2 Parts Water)	15-25% (site dependent)
Typical Increase in Strength	Mix ratio 1:1 (1 Part Flexible Additive & Fortifier to 2 Parts Water)	10-50% (mix dependent)

* SBR = Styrene/Butadiene/Rubber

The above information is a general specification only and does not make provision for specific site and project requirements. Please consult with the Technical Data Sheet or directly with Westbuild for a unique and tailored specification for your project.